

Convoluted Foam Absorber

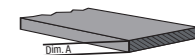

Material specifications

|                            |            |
|----------------------------|------------|
| Width x length             | 610 x 610  |
| Thickness adhesive         | 0,12       |
| Operating temperature (°C) | -50 to 120 |
| Colour                     | black      |



| Frequency (GHz) | Thickness (A) | Item number       |
|-----------------|---------------|-------------------|
| 4-100           | 38,1-76,2     | MWA-CFA-610x610xA |

Low Frequency Absorber



Material specifications

|                            |            |
|----------------------------|------------|
| Width x length             | 610 x 305  |
| Thickness adhesive         | 0,05       |
| Hardness (Shore A)         | 60-80      |
| Operating temperature (°C) | -50 to 120 |
| Flamability (UL94)         | V0         |
| Colour                     | dark grey  |

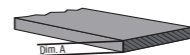

| Frequency (GHz) | Thickness (A) | Item number       |
|-----------------|---------------|-------------------|
| 0,5-4,0         | 0,2-1,0       | MWA-NFA-610x305xA |



- Other dimensions and frequencies on request
- Detailed information on our website [www.mtc.de/en](http://www.mtc.de/en)

Dimensions in mm (unless otherwise stated).

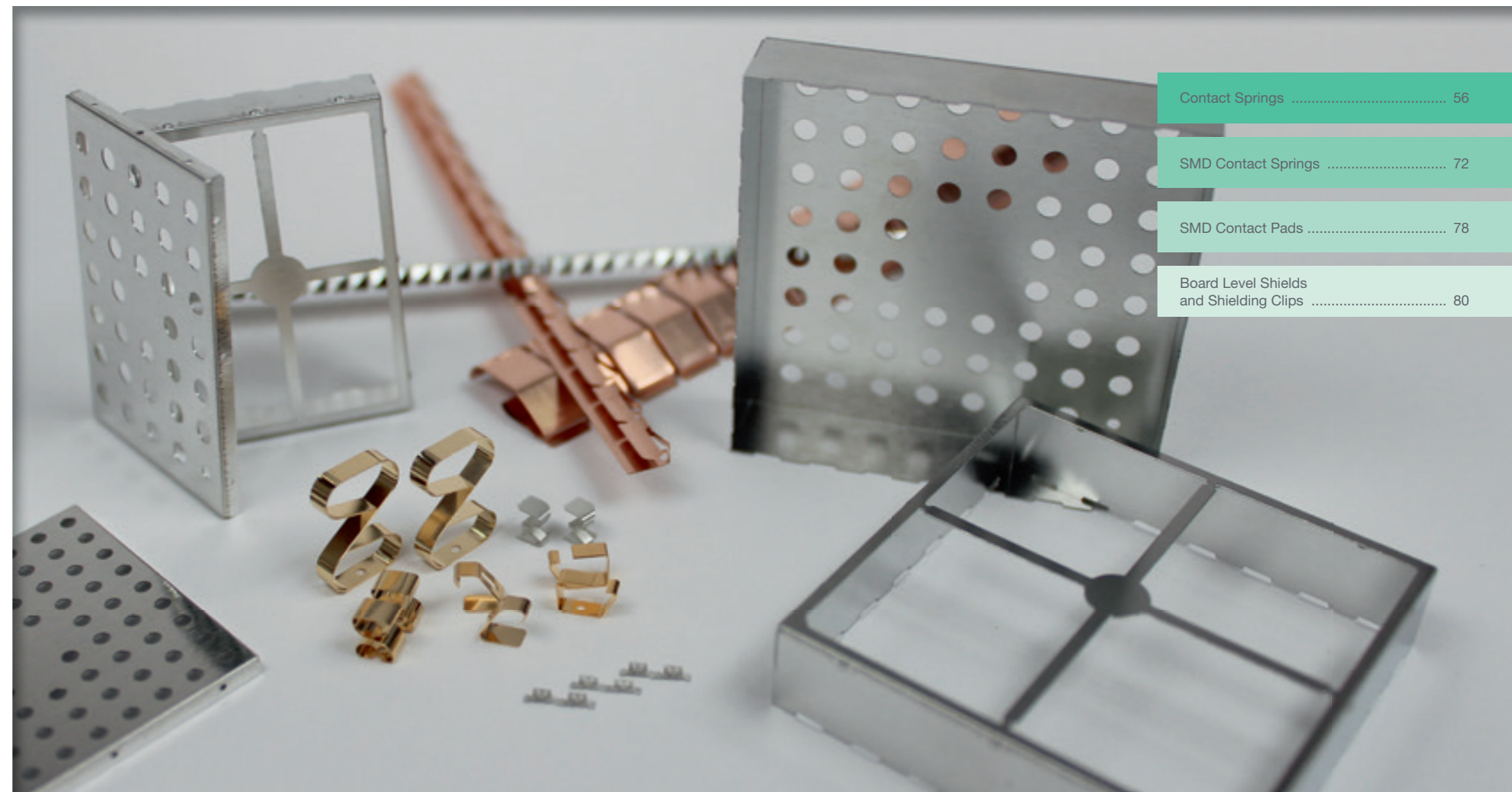

|   |    |
|---|----|
| Contact Springs                         | 56 |
| SMD Contact Springs                     | 72 |
| SMD Contact Pads                        | 78 |
| Board Level Shields and Shielding Clips | 80 |

# EMC Metal Parts



**Contact springs** are used to close gaps between two housing parts. To achieve an optimal shielding effect, the gap must be bridged electrically conductive.

Contact springs are made of **copper-beryllium (CuBe)** or stainless steel. Copper-beryllium is a material that offers **excellent spring characteristics** in combination with a **high material strength**. A further advantage is the high **corrosion resistance**. Copper-beryllium is also resistant against air, ozone, solvent and UV light. It can be used over a **wide temperature range** and shows **excellent thermal and electric conductivity**.

The **wide profile range** in combination with several mounting methods create an universally applicable shielding gasket. The easiest mounting methods are contact springs to **clip-on** and contact springs with a **double sided adhesive tape**.

**Soldering or welding** ensures the highest possible contact. Generally the **electrochemical reaction** should be considered to avoid galvanic corrosion.

As standard, contact strips are supplied in **bright clean surface (copper)**. On request a surface finish like tin plating, zinc plating, nickel plating, silver plating, gold plating etc. can be applied.



**Surface refinement**

| Plating                     | Material code |
|-----------------------------|---------------|
| blank (without)             | BL            |
| gold plated                 | AU            |
| silver plated               | AG            |
| tin matt                    | SN            |
| nickel matt                 | NI            |
| clear chromate zinc plating | ZN            |

Optionally contact springs can be **cut to length** on customer request. A cut can only be done in the gap between the fingers.

Due to manufacturing tolerances it is recommended to state the number of fingers rather than a given length.

The **standard program** already offers a **huge variety** of contact strips.

**Customer-specific** contact springs can be realized cost-effectively by **mtc**.



**Tolerances**

| Dimensions | Tolerance |
|------------|-----------|
| < 8        | +/- 0,10  |
| 8-25       | +/- 0,15  |
| 25-80      | +/- 0,25  |
| 80-250     | +/- 0,40  |
| 250-800    | +/- 0,50  |
| > 800      | +/- 1,50  |
| angle      | +/- 4°    |



**Contact springs provide the following advantages:**

- Different surfaces available
- Custom length available
- Different mounting methods available

# Contact Springs

Stick-on Contact springs with adhesive tape

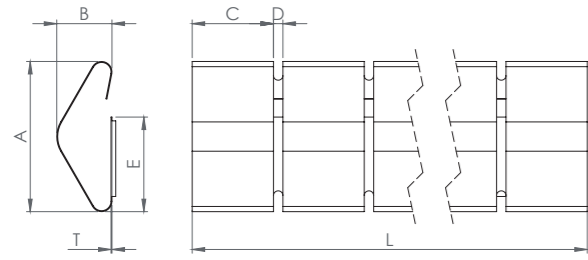

| Dim. A | Dim. B | Dim. C | Dim. D | Dim. E | Dim. T | Dim. L | Item number |
|--------|--------|--------|--------|--------|--------|--------|-------------|
| 7,9    | 2,9    | 4,3    | 0,5    | 5,0    | 0,05   | 406    | FCB-301     |
| 9,4    | 3,3    | 5,7    | 0,6    | 5,3    | 0,05   | 406    | FCB-302     |
| 15,2   | 5,7    | 8,7    | 0,8    | 6,4    | 0,08   | 608    | FCB-303     |
| 19,8   | 8,2    | 8,7    | 0,8    | 10,1   | 0,10   | 455    | FCB-304     |
| 27,9   | 10,7   | 11,7   | 1,0    | 17,0   | 0,10   | 455    | FCB-305     |
| 25,9   | 10,1   | 11,7   | 1,0    | 19,1   | 0,08   | 420    | FCB-371     |

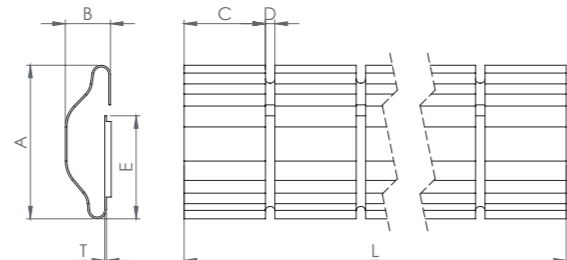

| Dim. A | Dim. B | Dim. C | Dim. D | Dim. E | Dim. T | Dim. L | Item number |
|--------|--------|--------|--------|--------|--------|--------|-------------|
| 8,1    | 2,3    | 4,3    | 0,5    | 5,5    | 0,09   | 406    | FCB-311     |
| 9,4    | 3,2    | 5,7    | 0,6    | 5,0    | 0,09   | 406    | FCB-312     |
| 15,2   | 5,5    | 3,9    | 0,8    | 7,0    | 0,09   | 455    | FCB-313     |
| 14,8   | 5,9    | 8,7    | 0,8    | 7,4    | 0,09   | 457    | FCB-314     |

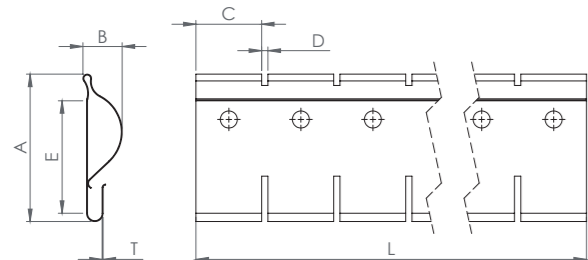

| Dim. A | Dim. B | Dim. C | Dim. D | Dim. E | Dim. T | Dim. L | Item number |
|--------|--------|--------|--------|--------|--------|--------|-------------|
| 13,0   | 3,5    | 5,8    | 0,6    | 9,9    | 0,08   | 406    | FCB-431     |
| 21,1   | 6,0    | 8,5    | 1,0    | 17,2   | 0,10   | 408    | FCB-441     |

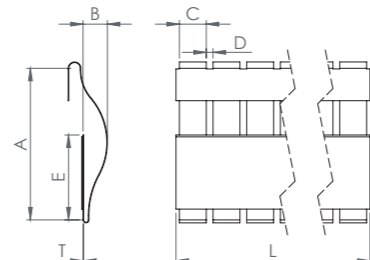

| Dim. A | Dim. B | Dim. C | Dim. D | Dim. E | Dim. T | Dim. L | Item number |
|--------|--------|--------|--------|--------|--------|--------|-------------|
| 15,2   | 2,3    | 2,5    | 0,6    | 8,0    | 0,06   | 407    | FCB-362     |
| 11,4   | 2,0    | 2,5    | 0,6    | 5,8    | 0,06   | 406    | FCB-822     |

Dimensions in mm (unless otherwise stated).

Stick-on Contact springs with adhesive tape

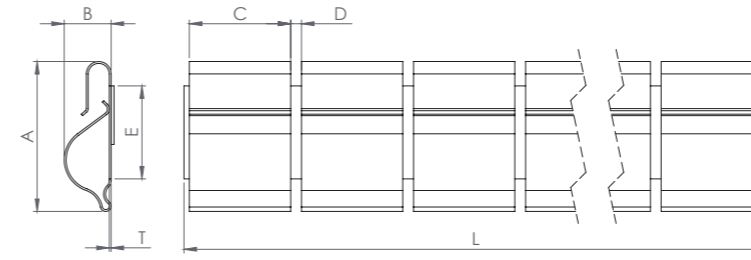

| Dim. A | Dim. B | Dim. C | Dim. D | Dim. E | Dim. T | Dim. L | Item number |
|--------|--------|--------|--------|--------|--------|--------|-------------|
| 6,4    | 2,0    | 4,3    | 0,5    | 4,0    | 0,08   | 406    | FCB-411     |
| 13,0   | 3,8    | 5,8    | 0,6    | 7,5    | 0,08   | 406    | FCB-413     |
| 19,3   | 5,8    | 8,7    | 0,8    | 10,5   | 0,10   | 608    | FCB-414     |

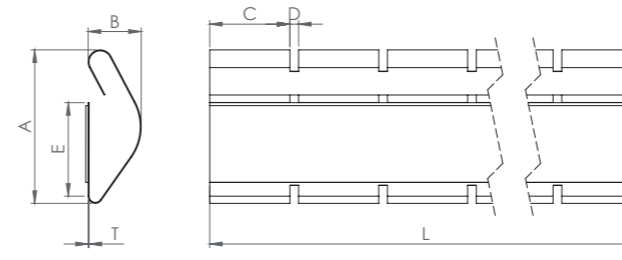

| Dim. A | Dim. B | Dim. C | Dim. D | Dim. E | Dim. T | Dim. L | Item number |
|--------|--------|--------|--------|--------|--------|--------|-------------|
| 8,1    | 2,8    | 4,2    | 0,5    | 4,9    | 0,05   | 409    | FCB-341     |
| 15,2   | 5,6    | 8,7    | 0,8    | 7,1    | 0,08   | 608    | FCB-342     |

Dimensions in mm (unless otherwise stated).

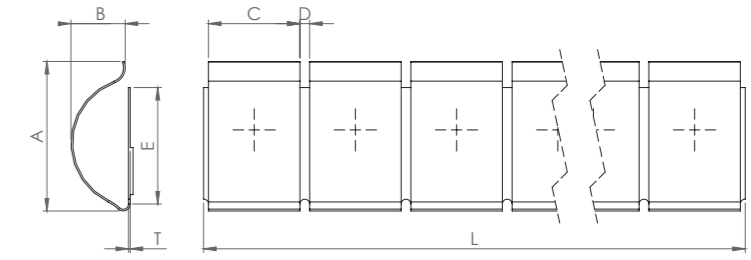

| Dim. A | Dim. B | Dim. C | Dim. D | Dim. E | Dim. T | Dim. L | Item number |
|--------|--------|--------|--------|--------|--------|--------|-------------|
| 7,1    | 2,6    | 4,3    | 0,5    | 5,5    | 0,08   | 406    | FCB-401     |
| 9,0    | 4,0    | 5,8    | 0,6    | 6,5    | 0,08   | 406    | FCB-402     |
| 14,5   | 5,6    | 8,7    | 0,8    | 10,0   | 0,09   | 609    | FCB-403     |
| 19,3   | 6,4    | 8,5    | 1,0    | 10,0   | 0,10   | 608    | FCB-404     |
| 29,7   | 12,3   | 11,7   | 1,0    | 17,0   | 0,18   | 304    | FCB-405     |
| 15,2   | 5,8    | 8,7    | 0,8    | 12,7   | 0,10   | 409    | FCB-423     |
| 17,0   | 7,9    | 8,5    | 1,0    | 13,5   | 0,10   | 610    | FCB-777     |

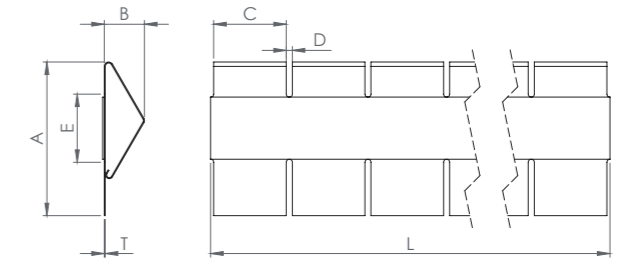

| Dim. A | Dim. B | Dim. C | Dim. D | Dim. E | Dim. T | Dim. L | Item number |
|--------|--------|--------|--------|--------|--------|--------|-------------|
| 12,7   | 3,3    | 6,0    | 0,5    | 5,6    | 0,08   | 403    | FCB-381     |



**Stick-on** Contact springs with adhesive tape

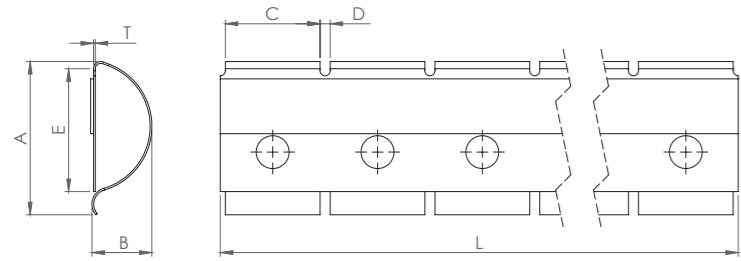

- Other dimensions on request
- Detailed information on our website [www.mtc.de/en](http://www.mtc.de/en)

| Dim. A | Dim. B | Dim. C | Dim. D | Dim. E | Dim. T | Dim. L | Item number |
|--------|--------|--------|--------|--------|--------|--------|-------------|
| 7,1    | 2,7    | 4,3    | 0,5    | 5,5    | 0,08   | 406    | FCB-421     |
| 9,4    | 3,6    | 5,8    | 0,6    | 6,7    | 0,08   | 406    | FCB-422     |
| 9,4    | 3,6    | 5,8    | 0,6    | 7,2    | 0,08   | 406    | FCB-857     |

**Clip-on** Contact springs to clip on

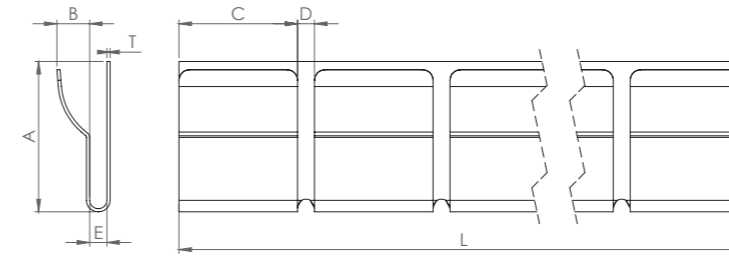

| Dim. A | Dim. B | Dim. C | Dim. D | Dim. E | Dim. T | Dim. L | Item number |
|--------|--------|--------|--------|--------|--------|--------|-------------|
| 7,1    | 1,5    | 5,6    | 0,8    | 0,8    | 0,15   | 404    | FCB-101     |

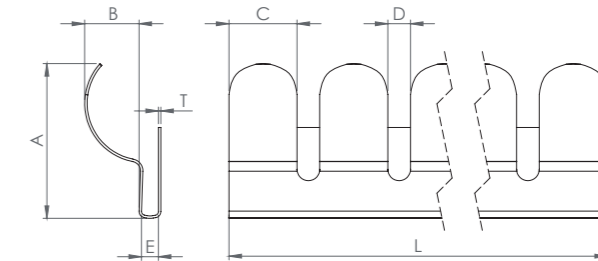

| Dim. A | Dim. B | Dim. C | Dim. D | Dim. E | Dim. T | Dim. L | Item number |
|--------|--------|--------|--------|--------|--------|--------|-------------|
| 8,0    | 2,9    | 3,6    | 1,2    | 0,8    | 0,13   | 407    | FCB-111     |
| 8,0    | 2,9    | 3,6    | 1,2    | 1,0    | 0,13   | 407    | FCB-112     |
| 8,0    | 2,9    | 3,6    | 1,2    | 1,5    | 0,13   | 407    | FCB-113     |
| 10,8   | 3,5    | 3,6    | 1,2    | 0,8    | 0,13   | 407    | FCB-121     |
| 10,8   | 3,5    | 3,6    | 1,2    | 1,0    | 0,13   | 407    | FCB-122     |
| 10,8   | 3,5    | 3,6    | 1,2    | 1,5    | 0,13   | 407    | FCB-123     |
| 11,4   | 2,5    | 3,6    | 1,2    | 1,8    | 0,08   | 407    | FCB-131     |
| 14,7   | 4,2    | 3,6    | 1,2    | 0,8    | 0,13   | 407    | FCB-151     |
| 14,0   | 4,2    | 3,6    | 1,2    | 1,0    | 0,13   | 500    | FCB-152     |
| 14,1   | 4,2    | 3,6    | 1,2    | 1,5    | 0,13   | 407    | FCB-153     |
| 7,8    | 3,3    | 3,5    | 1,2    | 1,6    | 0,10   | 406    | FCB-176     |

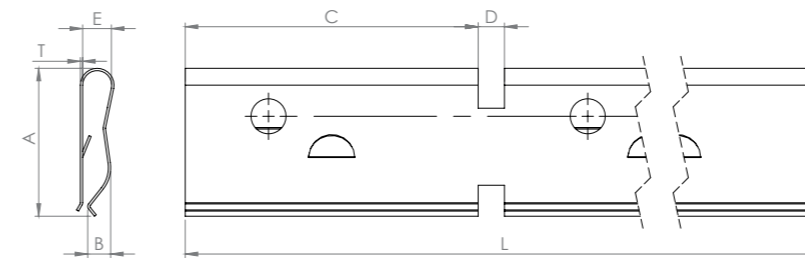

| Dim. A | Dim. B | Dim. C | Dim. D | Dim. E | Dim. T | Dim. L | Item number |
|--------|--------|--------|--------|--------|--------|--------|-------------|
| 6,4    | 1,0    | 12,7   | 1,1    | 1,2    | 0,10   | 414    | FCB-161     |

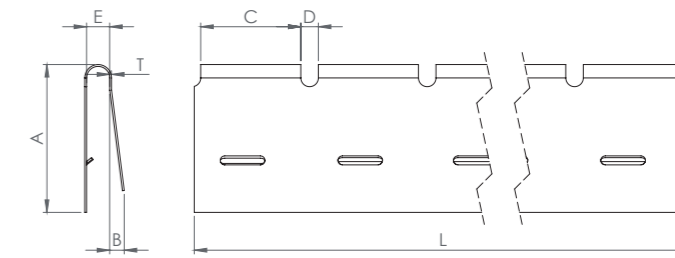

| Dim. A | Dim. B | Dim. C | Dim. D | Dim. E | Dim. T | Dim. L | Item number |
|--------|--------|--------|--------|--------|--------|--------|-------------|
| 6,4    | 0,6    | 4,3    | 0,8    | 1,0    | 0,08   | 407    | FCB-166     |

Dimensions in mm (unless otherwise stated).

Dimensions in mm (unless otherwise stated).

Clip-on Contact springs to clip on

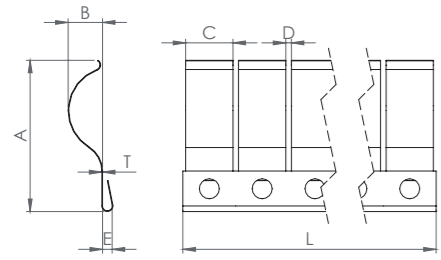

| Dim. A | Dim. B | Dim. C | Dim. D | Dim. E | Dim. T | Dim. L | Item number |
|--------|--------|--------|--------|--------|--------|--------|-------------|
| 27,2   | 6,2    | 8,5    | 1,0    | 2,0    | 0,12   | 406    | FCB-818     |

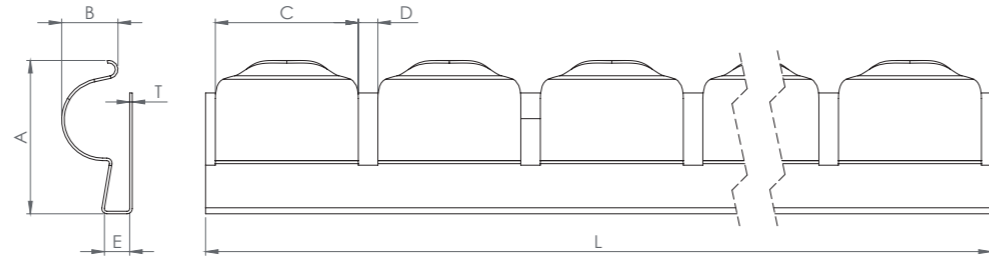

| Dim. A | Dim. B | Dim. C | Dim. D | Dim. E | Dim. T | Dim. L | Item number |
|--------|--------|--------|--------|--------|--------|--------|-------------|
| 5,9    | 3,0    | 5,6    | 0,8    | 1,0    | 0,10   | 396    | FCB-181     |

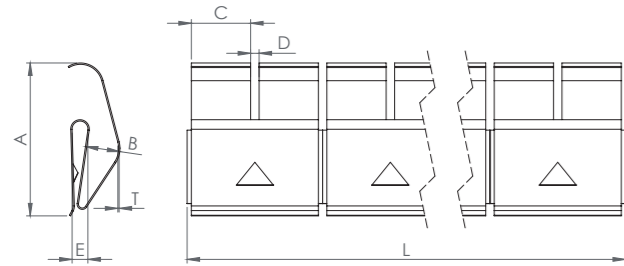

| Dim. A | Dim. B | Dim. C | Dim. D | Dim. E | Dim. T | Dim. L | Item number |
|--------|--------|--------|--------|--------|--------|--------|-------------|
| 14,6   | 3,6    | 5,6    | 0,8    | 1,0    | 0,13   | 409,6  | FCB-601-1,0 |
| 14,5   | 3,3    | 5,6    | 0,8    | 1,5    | 0,13   | 409,6  | FCB-601-1,5 |
| 14,2   | 3,1    | 5,6    | 0,8    | 2,0    | 0,13   | 409,6  | FCB-601-2,0 |
| 13,1   | 3,6    | 5,6    | 0,8    | 1,0    | 0,13   | 409,6  | FCB-599-1,0 |
| 13,1   | 3,3    | 5,6    | 0,8    | 1,5    | 0,13   | 409,6  | FCB-599-1,5 |
| 13,1   | 3,1    | 5,6    | 0,8    | 2,0    | 0,13   | 409,6  | FCB-599-2,0 |

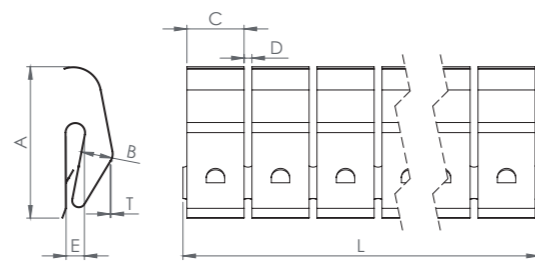

| Dim. A | Dim. B | Dim. C | Dim. D | Dim. E | Dim. T | Dim. L | Item number |
|--------|--------|--------|--------|--------|--------|--------|-------------|
| 14,8   | 3,1    | 5,6    | 0,8    | 1,8    | 0,10   | 380    | FCB-600     |

Dimensions in mm (unless otherwise stated).

Clip-on Contact springs to clip on

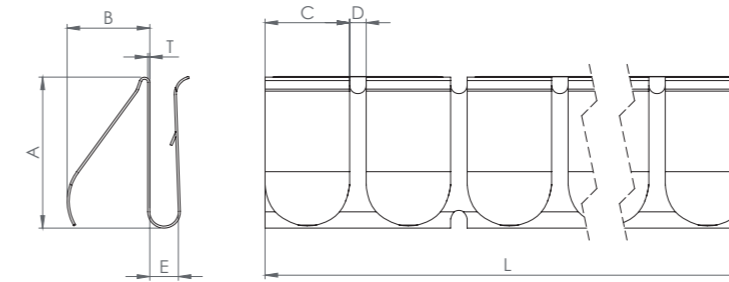

| Dim. A | Dim. B | Dim. C | Dim. D | Dim. E | Dim. T | Dim. L | Item number |
|--------|--------|--------|--------|--------|--------|--------|-------------|
| 9,5    | 5,2    | 5,3    | 1,0    | 1,8    | 0,13   | 406    | FCB-201     |
| 10,5   | 6,5    | 3,2    | 1,6    | 2,0    | 0,13   | 405    | FCB-211     |
| 10,5   | 6,5    | 8,0    | 1,6    | 2,0    | 0,13   | 405    | FCB-212     |

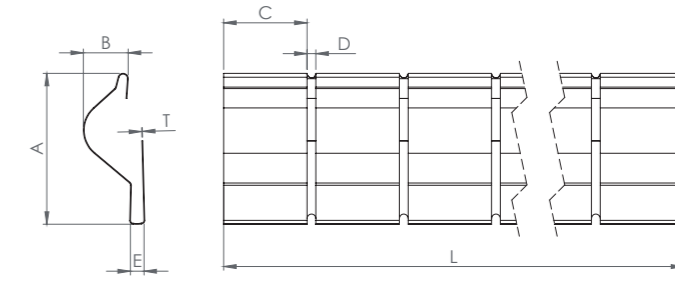

| Dim. A | Dim. B | Dim. C | Dim. D | Dim. E | Dim. T | Dim. L | Item number |
|--------|--------|--------|--------|--------|--------|--------|-------------|
| 10,2   | 3,1    | 5,7    | 0,6    | 0,9    | 0,05   | 409    | FCB-221     |
| 10,5   | 3,0    | 5,7    | 0,6    | 1,5    | 0,05   | 409    | FCB-222     |
| 16,3   | 5,4    | 8,7    | 0,8    | 1,5    | 0,09   | 455    | FCB-231     |

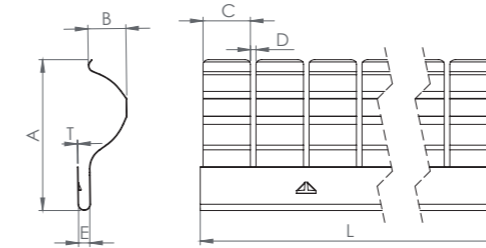

| Dim. A | Dim. B | Dim. C | Dim. D | Dim. E | Dim. T | Dim. L | Item number |
|--------|--------|--------|--------|--------|--------|--------|-------------|
| 27,0   | 6,8    | 8,5    | 1,0    | 2,0    | 0,13   | 494    | FCB-241     |
| 27,0   | 6,8    | 8,5    | 1,0    | 2,0    | 0,13   | 494    | FCB-251*    |

\* with lances

Dimensions in mm (unless otherwise stated).

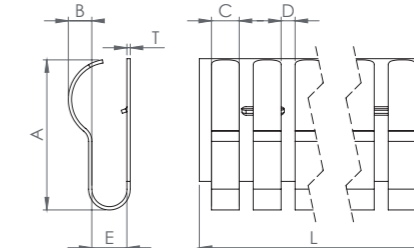

| Dim. A | Dim. B | Dim. C | Dim. D | Dim. E | Dim. T | Dim. L | Item number |
|--------|--------|--------|--------|--------|--------|--------|-------------|
| 6,9    | 1,1    | 1,3    | 0,6    | 1,6    | 0,15   | 406    | FCB-171     |



Other dimensions on request  
Detailed information on our website [www.mtc.de/en](http://www.mtc.de/en)

Clip-on Contact springs to clip on

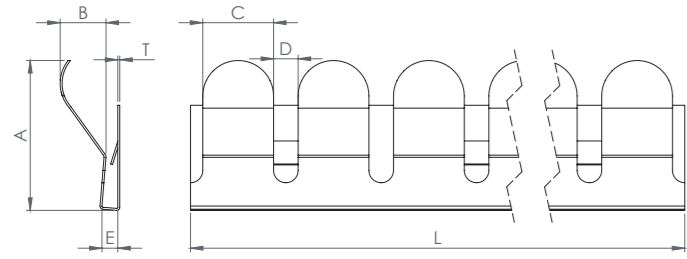

| Dim. A | Dim. B | Dim. C | Dim. D | Dim. E | Dim. T | Dim. L | Item number |
|--------|--------|--------|--------|--------|--------|--------|-------------|
| 7,6    | 2,9    | 6,3    | 1,3    | 0,8    | 0,10   | 427    | FCB-186     |

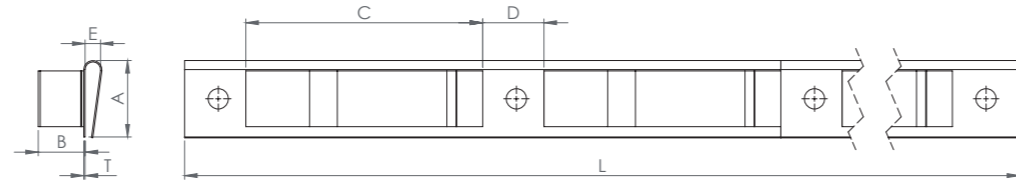

| Dim. A | Dim. B | Dim. C | Dim. D | Dim. E | Dim. T | Dim. L | Item number |
|--------|--------|--------|--------|--------|--------|--------|-------------|
| 7,5    | 4,6    | 23,2   | 6,0    | 1,5    | 0,13   | 433    | FCB-291     |

Clip-on Contact springs to clip on

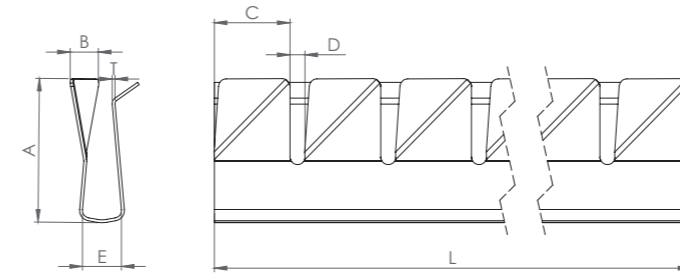

| Dim. A | Dim. B | Dim. C | Dim. D | Dim. E | Dim. T | Dim. L | Item number |
|--------|--------|--------|--------|--------|--------|--------|-------------|
| 3,8    | 0,8    | 2,0    | 0,4    | 1,0    | 0,08   | 405    | FCB-531*    |
| 3,8    | 0,8    | 2,0    | 0,4    | 1,5    | 0,08   | 405    | FCB-532*    |
| 4,1    | 0,7    | 2,0    | 0,4    | 1,0    | 0,08   | 24,1   | FCB-533     |
| 5,5    | 0,6    | 3,4    | 0,4    | 1,5    | 0,08   | 406    | FCB-536     |

\* available with lances

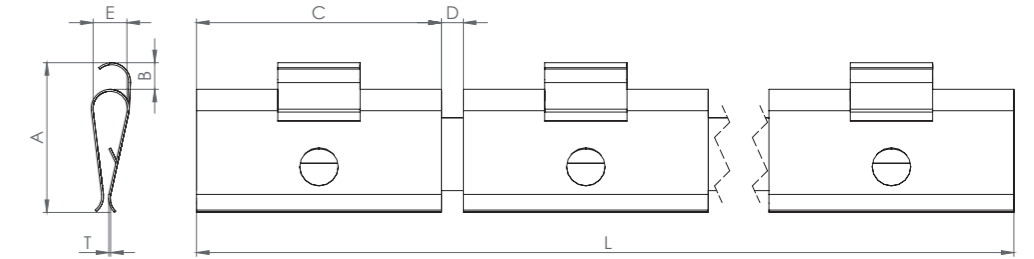

| Dim. A | Dim. B | Dim. C | Dim. D | Dim. E | Dim. T | Dim. L | Item number |
|--------|--------|--------|--------|--------|--------|--------|-------------|
| 7,8    | 1,4    | 12,7   | 1,1    | 1,8    | 0,10   | 415    | FCB-602     |

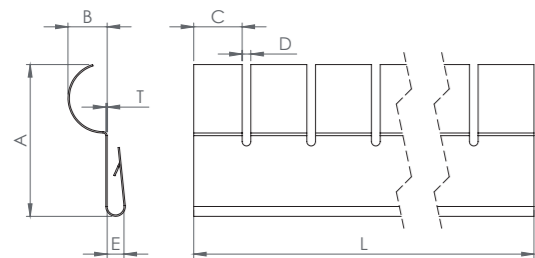

| Dim. A | Dim. B | Dim. C | Dim. D | Dim. E | Dim. T | Dim. L | Item number |
|--------|--------|--------|--------|--------|--------|--------|-------------|
| 11,1   | 2,9    | 3,6    | 0,6    | 1,2    | 0,10   | 32,1   | FCB-187     |

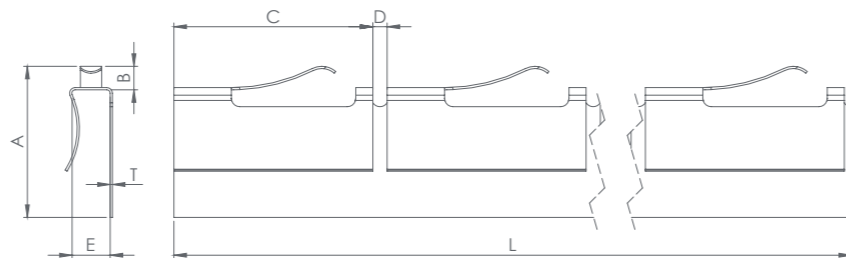

| Dim. A | Dim. B | Dim. C | Dim. D | Dim. E | Dim. T | Dim. L | Item number |
|--------|--------|--------|--------|--------|--------|--------|-------------|
| 5,4    | 0,8    | 7,1    | 0,5    | 1,4    | 0,08   | 404    | FCB-296     |

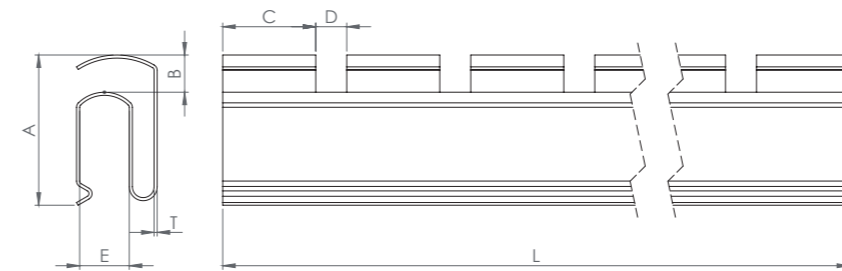

| Dim. A | Dim. B | Dim. C | Dim. D | Dim. E | Dim. T | Dim. L | Item number |
|--------|--------|--------|--------|--------|--------|--------|-------------|
| 4,9    | 1,2    | 3,0    | 1,0    | 1,6    | 0,10   | 60     | FCB-603     |

Dimensions in mm (unless otherwise stated).

Dimensions in mm (unless otherwise stated).



- Other dimensions on request
- Detailed information on our website [www.mtc.de/en](http://www.mtc.de/en)

**Clip-on** Contact springs to clip on

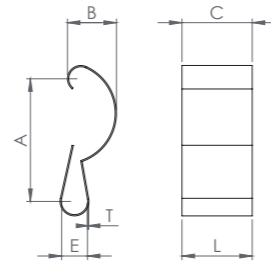
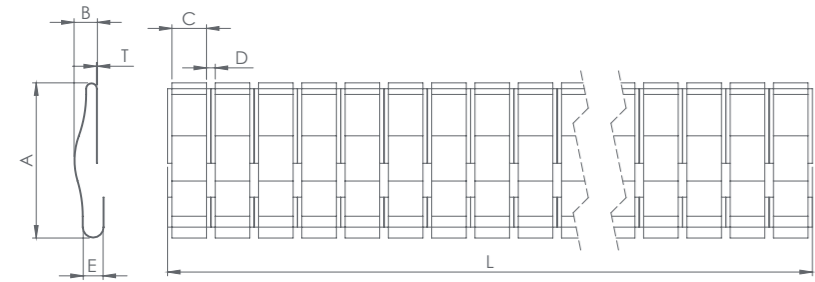

| Dim. A | Dim. B | Dim. C | Dim. D | Dim. E | Dim. T | Dim. L | Item number |
|--------|--------|--------|--------|--------|--------|--------|-------------|
| 11,4   | 1,7    | 2,5    | 0,6    | 1,5    | 0,07   | 406    | FCB-821     |

| Dim. A | Dim. B | Dim. C | Dim. E | Dim. T | Dim. L | Item number |
|--------|--------|--------|--------|--------|--------|-------------|
| 9,1    | 2,7    | 4,3    | 1,6    | 0,08   | 4,3    | FCB-843     |

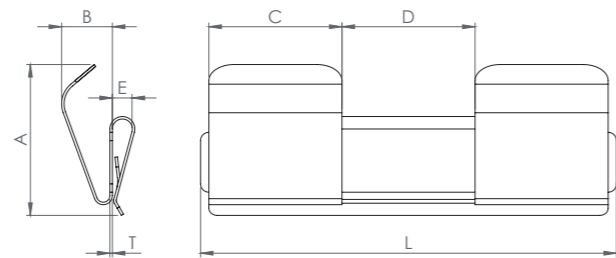
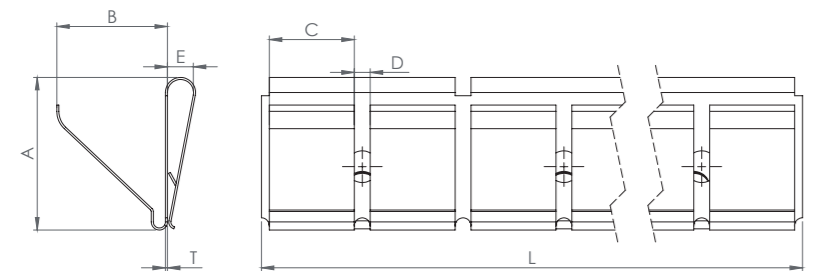

| Dim. A | Dim. B | Dim. C | Dim. D | Dim. E | Dim. T | Dim. L | Item number |
|--------|--------|--------|--------|--------|--------|--------|-------------|
| 9,6    | 7,0    | 5,4    | 1,0    | 1,6    | 0,13   | 405    | FCB-261     |

| Dim. A | Dim. B | Dim. C | Dim. D | Dim. E | Dim. T | Dim. L | Item number |
|--------|--------|--------|--------|--------|--------|--------|-------------|
| 9,1    | 3,1    | 8,0    | 8,0    | 1,2    | 0,15   | 25     | FCB-863     |

Dimensions in mm (unless otherwise stated).

**Special Mounting** Contact springs to screw, to solder and to clinch

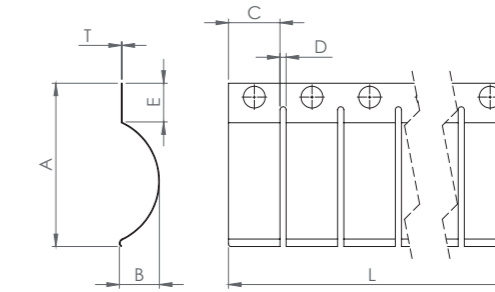
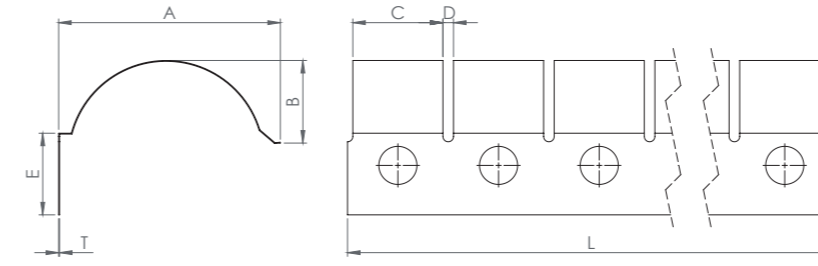

| Dim. A | Dim. B | Dim. C | Dim. D | Dim. E | Dim. T | Dim. L | Item number |
|--------|--------|--------|--------|--------|--------|--------|-------------|
| 14,6   | 7,8    | 8,5    | 1,0    | 7,7    | 0,08   | 409    | FCB-811     |
| 29,2   | 10,2   | 11,7   | 1,0    | 19,0   | 0,13   | 406    | FCB-812     |
| 9,4    | 3,6    | 5,8    | 0,6    | 8,1    | 0,08   | 406    | FCB-815     |
| 18,7   | 6,7    | 8,5    | 1,0    | 8,7    | 0,13   | 406    | FCB-816     |
| 8,4    | 2,8    | 4,3    | 0,5    | 5,7    | 0,08   | 408    | FCB-823     |
| 28,7   | 10,8   | 11,7   | 1,0    | 19,1   | 0,18   | 406    | FCB-824     |
| 9,4    | 3,5    | 5,8    | 0,6    | 8,1    | 0,08   | 406    | FCB-847     |

| Dim. A | Dim. B | Dim. C | Dim. D | Dim. E | Dim. T | Dim. L | Item number |
|--------|--------|--------|--------|--------|--------|--------|-------------|
| 27,0   | 6,3    | 8,5    | 1,0    | 6,4    | 0,08   | 408    | FCB-801     |
| 41,4   | 10,4   | 12,7   | 1,0    | 8,0    | 0,18   | 405    | FCB-802     |
| 41,4   | 10,4   | 12,7   | 1,0    | 9,2    | 0,18   | 406    | FCB-803     |
| 42,3   | 11,5   | 11,5   | 1,0    | 9,5    | 0,10   | 406    | FCB-832     |

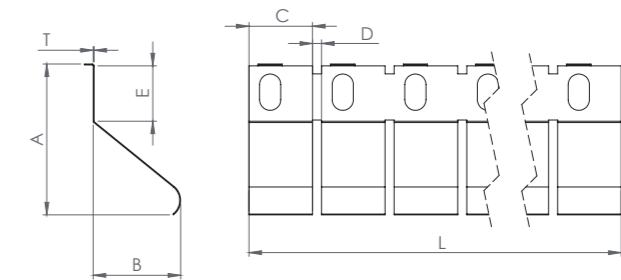
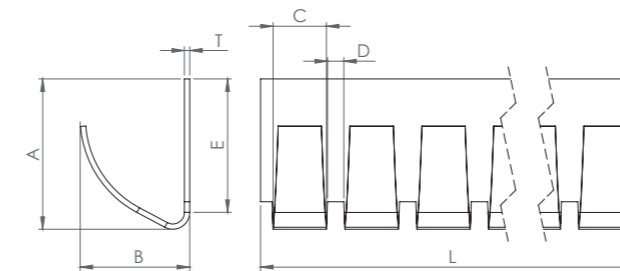

| Dim. A | Dim. B | Dim. C | Dim. D | Dim. E | Dim. T | Dim. L | Item number |
|--------|--------|--------|--------|--------|--------|--------|-------------|
| 7,1    | 5,1    | 2,5    | 1,0    | 6,3    | 0,25   | 406    | FCB-391     |

| Dim. A | Dim. B | Dim. C | Dim. D | Dim. E | Dim. T | Dim. L | Item number |
|--------|--------|--------|--------|--------|--------|--------|-------------|
| 24,9   | 14,5   | 10,5   | 1,5    | 9,2    | 0,15   | 406    | FCB-835     |
| 17,5   | 6,6    | 9,0    | 1,0    | 10,1   | 0,10   | 9      | FCB-856     |

Dimensions in mm (unless otherwise stated).

**Snap-in** Contact springs to slide on (two legs)

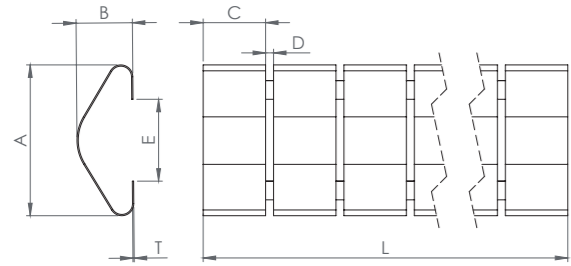

| Dim. A | Dim. B | Dim. C | Dim. D | Dim. E | Dim. T | Dim. L | Item number |
|--------|--------|--------|--------|--------|--------|--------|-------------|
| 20,3   | 8,1    | 8,7    | ---    | 10,1   | 0,10   | 8,7    | FCB-721     |
| 15,3   | 5,7    | 6,3    | 0,8    | 8,3    | 0,08   | 400    | FCB-748     |
| 11,0   | 3,8    | 5,3    | 0,7    | 2,7    | 0,07   | 406    | FCB-871     |

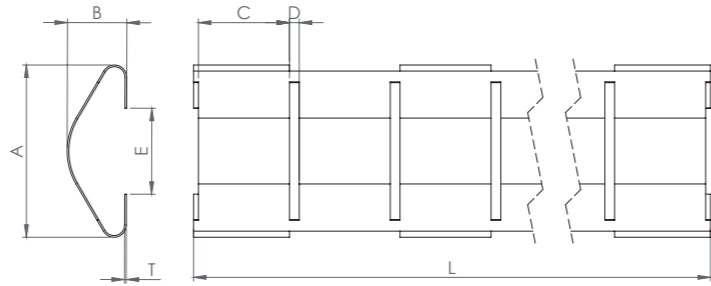

| Dim. A | Dim. B | Dim. C | Dim. D | Dim. E | Dim. T | Dim. L | Item number |
|--------|--------|--------|--------|--------|--------|--------|-------------|
| 8,1    | 2,8    | 4,3    | 0,5    | 4,1    | 0,08   | 404    | FCB-791     |
| 9,4    | 3,6    | 4,5    | 0,7    | 5,0    | 0,08   | 406    | FCB-792     |

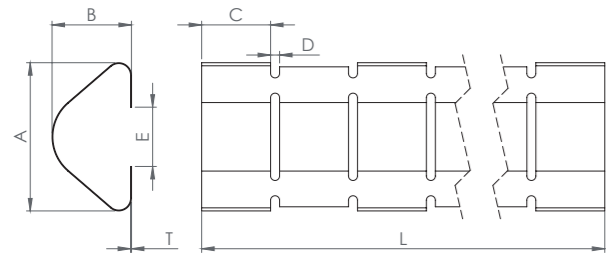

| Dim. A | Dim. B | Dim. C | Dim. D | Dim. E | Dim. T | Dim. L | Item number |
|--------|--------|--------|--------|--------|--------|--------|-------------|
| 14,0   | 7,5    | 6,5    | 0,9    | 5,6    | 0,08   | 403    | FCB-858     |

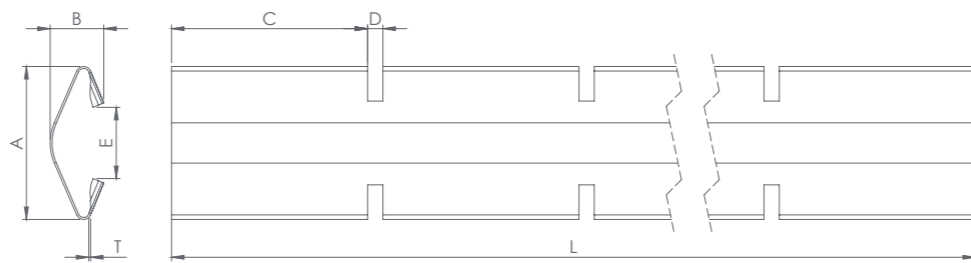

| Dim. A | Dim. B | Dim. C | Dim. D | Dim. E | Dim. T | Dim. L | Item number |
|--------|--------|--------|--------|--------|--------|--------|-------------|
| 4,7    | 1,7    | 6,0    | 0,5    | 2,5    | 0,05   | 234    | FCB-846     |

Dimensions in mm (unless otherwise stated).

**Snap-in** Contact springs to slide on (two legs)

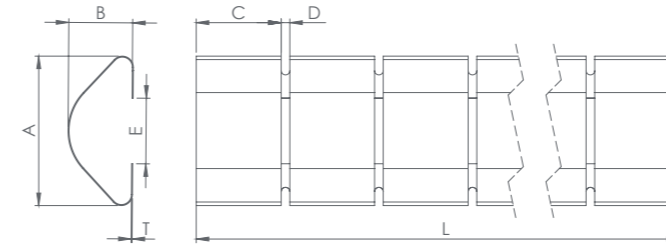

| Dim. A | Dim. B | Dim. C | Dim. D | Dim. E | Dim. T | Dim. L | Item number |
|--------|--------|--------|--------|--------|--------|--------|-------------|
| 7,6    | 3,3    | 4,3    | 0,4    | 3,3    | 0,05   | 333    | FCB-732     |
| 8,1    | 2,8    | 4,3    | 0,5    | 3,8    | 0,08   | 402    | FCB-736     |
| 9,4    | 3,3    | 5,7    | 0,6    | 5,1    | 0,08   | 406    | FCB-739     |
| 7,9    | 3,1    | 5,9    | 0,5    | 2,3    | 0,08   | 406    | FCB-761     |
| 8,9    | 2,8    | 4,3    | 0,5    | 2,1    | 0,08   | 406    | FCB-762     |
| 8,9    | 3,2    | 4,3    | 0,5    | 2,8    | 0,08   | 406    | FCB-763     |
| 8,3    | 2,6    | 4,3    | 0,5    | 3,9    | 0,05   | 408    | FCB-771     |
| 5,0    | 2,0    | 2,7    | 0,5    | 1,6    | 0,08   | 363    | FCB-781     |

Dimensions in mm (unless otherwise stated).



- Other dimensions on request
- Detailed information on our website [www.mtc.de/en](http://www.mtc.de/en)



Twisted contact

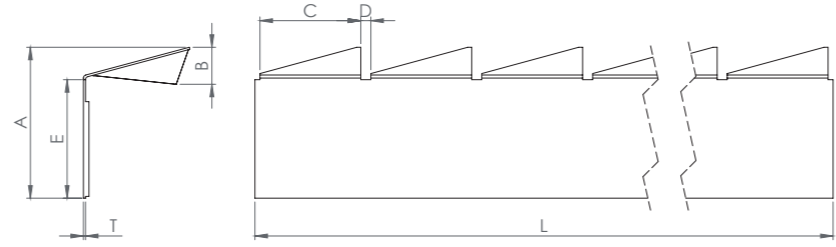
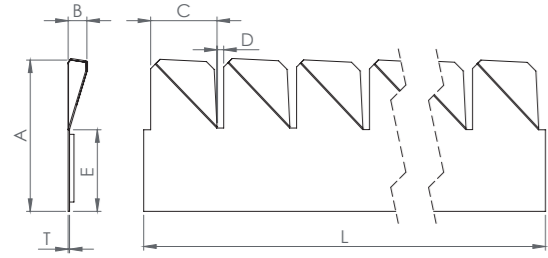

| Dim. A | Dim. B | Dim. C | Dim. D | Dim. E | Dim. T | Dim. L | Item number |
|--------|--------|--------|--------|--------|--------|--------|-------------|
| 8,7    | 1,0    | 3,8    | 0,4    | 4,7    | 0,08   | 406    | FCB-504     |
| 5,9    | 0,8    | 2,4    | 0,4    | 3,6    | 0,08   | 610    | FCB-571     |

| Dim. A | Dim. B | Dim. C | Dim. D | Dim. E | Dim. T | Dim. L | Item number |
|--------|--------|--------|--------|--------|--------|--------|-------------|
| 5,7    | 1,4    | 3,8    | 0,4    | 4,5    | 0,08   | 504    | FCB-505     |
| 4,1    | 0,8    | 2,0    | 0,4    | 3,6    | 0,08   | 501    | FCB-524     |

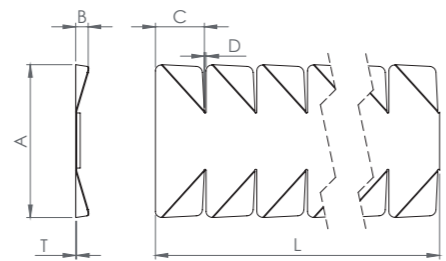
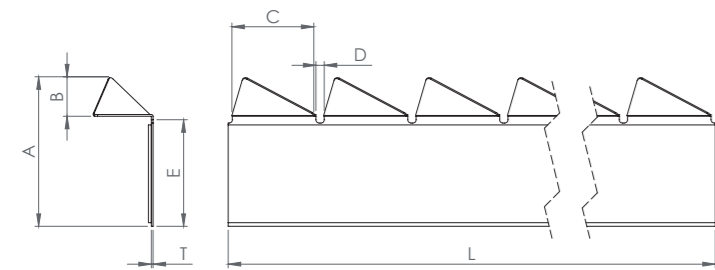

| Dim. A | Dim. B | Dim. C | Dim. D | Dim. E | Dim. T | Dim. L | Item number |
|--------|--------|--------|--------|--------|--------|--------|-------------|
| 6,8    | 1,8    | 3,5    | 0,4    | 2,8    | 0,08   | 406    | FCB-506     |

| Dim. A | Dim. B | Dim. C | Dim. D | Dim. T | Dim. L | Item number |
|--------|--------|--------|--------|--------|--------|-------------|
| 12,7   | 1,8    | 3,8    | 0,4    | 0,08   | 406    | FCB-510     |

Dimensions in mm (unless otherwise stated).

Twisted contact

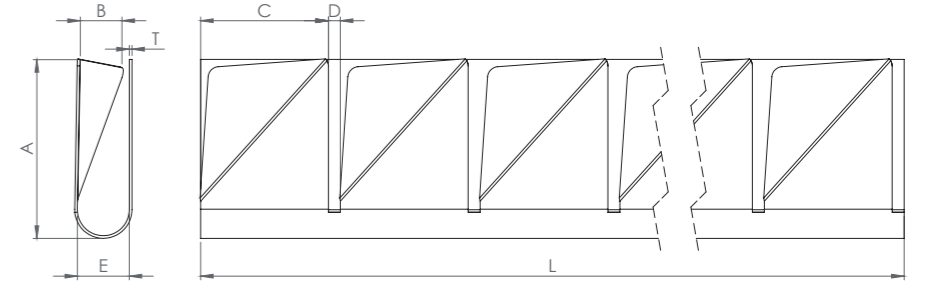
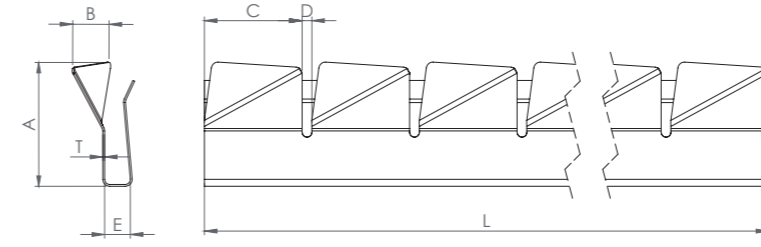

| Dim. A | Dim. B | Dim. C | Dim. D | Dim. E | Dim. T | Dim. L | Item number |
|--------|--------|--------|--------|--------|--------|--------|-------------|
| 4,8    | 1,4    | 3,8    | 0,4    | 1,0    | 0,08   | 407    | FCB-511     |
| 4,6    | 1,5    | 3,8    | 0,4    | 1,5    | 0,08   | 407    | FCB-512     |
| 4,8    | 1,8    | 3,8    | 0,4    | 2,0    | 0,08   | 407    | FCB-513     |
| 6,4    | 1,8    | 3,8    | 0,4    | 1,0    | 0,08   | 407    | FCB-514     |
| 6,4    | 1,8    | 3,8    | 0,4    | 1,5    | 0,08   | 407    | FCB-515     |
| 6,4    | 1,8    | 3,8    | 0,4    | 2,0    | 0,08   | 407    | FCB-516     |

| Dim. A | Dim. B | Dim. C | Dim. D | Dim. E | Dim. T | Dim. L | Item number |
|--------|--------|--------|--------|--------|--------|--------|-------------|
| 5,3    | 1,3    | 3,8    | 0,4    | 1,5    | 0,08   | 403    | FCB-581     |
| 3,8    | 1,0    | 2,0    | 0,4    | 1,2    | 0,05   | 192    | FCB-582     |



- Other dimensions on request
- Detailed information on our website [www.mtc.de/en](http://www.mtc.de/en)

Dimensions in mm (unless otherwise stated).



**SMD contact springs** are ideal for **automatic assembly** on printed circuit boards. They are soldered by the standard-reflow-soldering process.

The standard base material used for SMD contact springs is **copper-beryllium (CuBe)**. However, other materials such as stainless steel, titanium copper or phosphorus bronze can also be supplied.

Copper-beryllium is **easy to work** and **resistant to corrosion and abrasion**. Even high temperatures and temperature fluctuations or high mechanical

stresses have only a low influence on its **excellent connection properties**. In addition, CuBe is **extraordinarily elastic** and offers a high endurance strength.

As standard, SMD springs are **gold-plated** since, with the exception of “royal water” (a mixture of hydrochloric acid and nitric acid), acids are not aggressive towards gold and therefore gold provides **excellent corrosion protection**. In addition, the gold-plated surface is ideal for soldering. Of course, other finishes (for example tin or nickel) can be ordered, too.

# SMD Contact Springs

SMD contact springs are **very resistant** and have an **almost unlimited** working life.

SMD contact springs can be supplied in a very **wide range of dimensions and shapes**. The standard range includes a large number of different spring types in heights from 1,5 to 13 mm. Depending on customer requirements and the individual installation situation, **customized SMD springs** can be supplied at low tooling costs and part prices.



For reasons of space, the SMD contact springs have been summarized in types. Only a schematic drawing is used for the presentation of an SMD type.

**It is necessary to request the technical documentation with the proposal for the pad before you start the design of the printed circuit board. You can also find it on our website.**



## Surface refinement

| Plating                | Material code |
|------------------------|---------------|
| gold plated (standard) | AU            |
| tin plated             | SN            |



**SMD contact springs provide the following advantages:**

- Available in different dimensions and types
- Ideal for automatic assembly
- Excellent corrosion protection by a gold plated surface

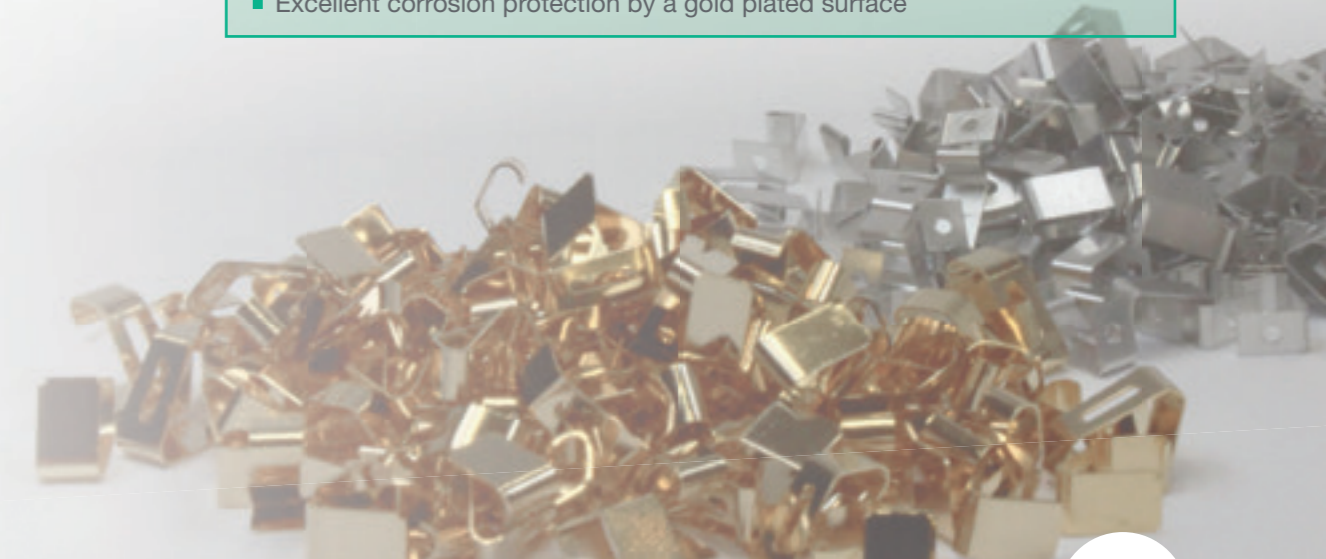

Type 1

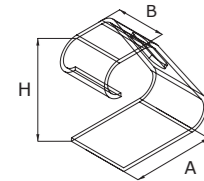

| Dim. A | Dim. B | Dim. H | Item number              |
|--------|--------|--------|--------------------------|
| 4,5    | 2,5    | 3,5    | FCB-01CG2545035B1-XX-SMD |
| 4,5    | 2,5    | 3,6    | FCB-01CG2545036B-XX-SMD  |
| 3,0    | 2,0    | 4,0    | FCB-01CG2030040B-XX-SMD  |
| 4,8    | 2,5    | 4,5    | FCB-01CG2548045B-XX-SMD  |
| 4,5    | 2,0    | 4,8    | FCB-01CG2045048B-XX-SMD  |

Type 2

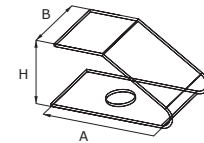

| Dim. A | Dim. B | Dim. H | Item number             |
|--------|--------|--------|-------------------------|
| 2,7    | 1,5    | 1,5    | FCB-02CG1527015B-XX-SMD |
| 3,8    | 2,0    | 2,0    | FCB-02CG2038020B-XX-SMD |

Type 3

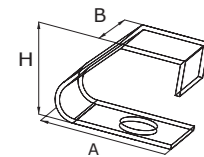

| Dim. A | Dim. B | Dim. H | Item number              |
|--------|--------|--------|--------------------------|
| 3,2    | 1,5    | 1,5    | FCB-03CG1532015B-XX-SMD  |
| 3,2    | 2,0    | 1,5    | FCB-03CG2032015B-XX-SMD  |
| 2,7    | 1,5    | 2,0    | FCB-03CG1527020T-XX-SMD* |
| 4,0    | 2,0    | 2,1    | FCB-03CG2040021B-XX-SMD  |
| 3,2    | 2,0    | 3,5    | FCB-03CG2032035B-XX-SMD  |
| 5,0    | 2,5    | 3,6    | FCB-03019-XX-SMD         |
| 3,0    | 2,0    | 4,0    | FCB-03025-XX-SMD         |
| 4,1    | 2,5    | 4,3    | FCB-03023-XX-SMD         |
| 4,0    | 2,5    | 4,0    | FCB-03017-XX-SMD         |
| 6,2    | 2,5    | 4,8    | FCB-03CG2562048B-XX-SMD  |
| 4,0    | 2,0    | 5,5    | FCB-03CG2040055B-XX-SMD  |
| 7,0    | 2,5    | 5,5    | FCB-03008-XX-SMD         |

Type 4

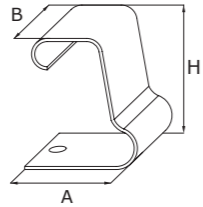

| Dim. A | Dim. B | Dim. H | Item number             |
|--------|--------|--------|-------------------------|
| 4,3    | 2,5    | 3,5    | FCB-04CG2543035B-XX-SMD |
| 4,0    | 2,5    | 5,0    | FCB-047G2540050B-XX-SMD |
| 4,3    | 2,5    | 5,0    | FCB-04CG2543050B-XX-SMD |
| 4,0    | 2,0    | 5,3    | FCB-04CG2040053B-XX-SMD |
| 4,0    | 2,5    | 5,4    | FCB-044G2540054B-XX-SMD |
| 6,0    | 2,0    | 6,0    | FCB-04CG2060060B-XX-SMD |

Type 5

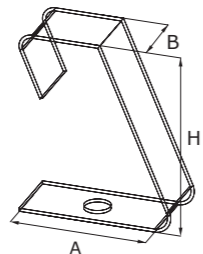

| Dim. A | Dim. B | Dim. H | Item number             |
|--------|--------|--------|-------------------------|
| 3,5    | 2,0    | 3,5    | FCB-05CG2035035B-XX-SMD |
| 3,0    | 2,5    | 4,0    | FCB-05CG2530040B-XX-SMD |
| 4,0    | 2,5    | 5,0    | FCB-05CG2540050B-XX-SMD |
| 4,7    | 2,0    | 5,7    | FCB-05CG2047057B-XX-SMD |

Type 6

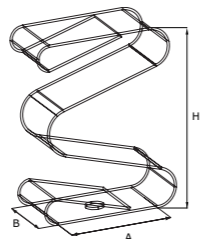

| Dim. A | Dim. B | Dim. H | Item number             |
|--------|--------|--------|-------------------------|
| 4,8    | 2,5    | 7,0    | FCB-063G2548070B-XX-SMD |
| 7,0    | 2,5    | 9,0    | FCB-063G2570090B-XX-SMD |
| 6,0    | 3,0    | 10,0   | FCB-063G3060100B-XX-SMD |

Dimensions in mm (unless otherwise stated).

Type 7

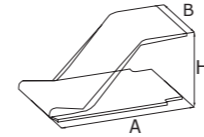

| Dim. A | Dim. B | Dim. H | Item number             |
|--------|--------|--------|-------------------------|
| 4,0    | 2,2    | 2,2    | FCB-07004-XX-SMD        |
| 4,0    | 2,2    | 2,2    | FCB-07CG2240022B-XX-SMD |

Type 8

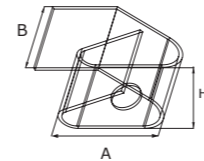

| Dim. A | Dim. B | Dim. H | Item number             |
|--------|--------|--------|-------------------------|
| 3,0    | 2,0    | 2,5    | FCB-085G2030025B-XX-SMD |

Type 9

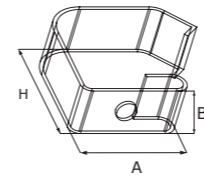

| Dim. A | Dim. B | Dim. H | Item number             |
|--------|--------|--------|-------------------------|
| 5,8    | 2,0    | 5,0    | FCB-09CG2058050B-XX-SMD |

Type 10

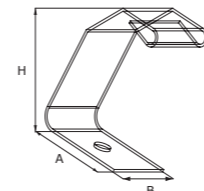

| Dim. A | Dim. B | Dim. H | Item number             |
|--------|--------|--------|-------------------------|
| 4,5    | 2,5    | 4,8    | FCB-10CG2545048B-XX-SMD |
| 4,0    | 2,5    | 5,5    | FCB-10CG2540055B-XX-SMD |
| 4,0    | 2,5    | 6,0    | FCB-10CG2540060B-XX-SMD |

Dimensions in mm (unless otherwise stated).

Type 11

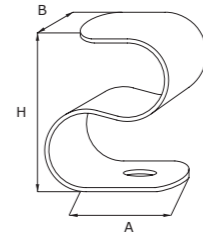

| Dim. A | Dim. B | Dim. H | Item number             |
|--------|--------|--------|-------------------------|
| 3,0    | 2,0    | 3,1    | FCB-11SG2030031B-XX-SMD |
| 3,0    | 2,0    | 3,6    | FCB-11SG2030036B-XX-SMD |

Type 12

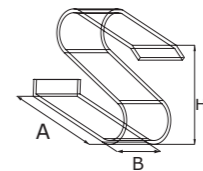

| Dim. A | Dim. B | Dim. H | Item number             |
|--------|--------|--------|-------------------------|
| 2,7    | 1,3    | 2,2    | FCB-12ZG1327022B-XX-SMD |
| 2,7    | 2,0    | 2,2    | FCB-12ZG2027022B-XX-SMD |
| 3,5    | 1,8    | 2,5    | FCB-12ZG1835025B-XX-SMD |

Type 13

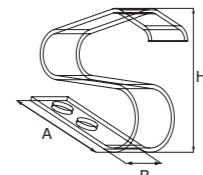

| Dim. A | Dim. B | Dim. H | Item number             |
|--------|--------|--------|-------------------------|
| 3,7    | 1,2    | 3,2    | FCB-13ZG1237032B-XX-SMD |

Type 14

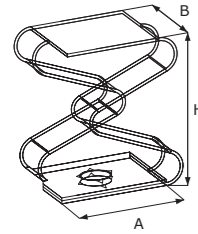

| Dim. A | Dim. B | Dim. H | Item number             |
|--------|--------|--------|-------------------------|
| 3,5    | 2,5    | 4,0    | FCB-14XG2535040B-XX-SMD |
| 8,5    | 3,5    | 9,8    | FCB-14XG3585098B-XX-SMD |

Type 17

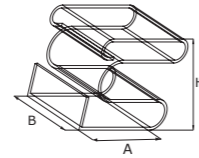

| Dim. A | Dim. B | Dim. H | Item number             |
|--------|--------|--------|-------------------------|
| 3,0    | 2,0    | 2,5    | FCB-173G2030025B-XX-SMD |
| 3,0    | 2,0    | 3,0    | FCB-173G2030030B-XX-SMD |
| 3,0    | 2,0    | 3,5    | FCB-173G2030035B-XX-SMD |
| 3,5    | 2,0    | 4,2    | FCB-173G2035042B-XX-SMD |
| 3,8    | 2,0    | 6,2    | FCB-173G2038062B-XX-SMD |
| 4,5    | 2,0    | 7,0    | FCB-173G2045070B-XX-SMD |

Type 15

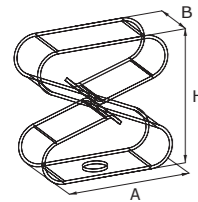

| Dim. A | Dim. B | Dim. H | Item number             |
|--------|--------|--------|-------------------------|
| 4,0    | 2,0    | 3,7    | FCB-158G2040037B-XX-SMD |
| 4,5    | 2,0    | 4,5    | FCB-158G2045045B-XX-SMD |
| 7,0    | 2,5    | 6,2    | FCB-158G2570062B-XX-SMD |
| 7,0    | 2,5    | 7,5    | FCB-158G2570075B-XX-SMD |
| 7,0    | 2,5    | 9,0    | FCB-158G2570090B-XX-SMD |
| 7,0    | 2,5    | 10,0   | FCB-158G2570100B-XX-SMD |
| 9,0    | 2,5    | 13,0   | FCB-158G2590130B-XX-SMD |

Type 18

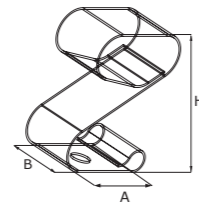

| Dim. A | Dim. B | Dim. H | Item number            |
|--------|--------|--------|------------------------|
| 4,5    | 2,5    | 6,0    | FCB-185G2545060-XX-SMD |

Type 16

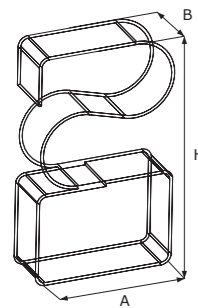

| Dim. A | Dim. B | Dim. H | Item number             |
|--------|--------|--------|-------------------------|
| 4,5    | 2,0    | 7,0    | FCB-16SG2045070B-XX-SMD |
| 6,5    | 2,5    | 8,0    | FCB-16SG2565080B-XX-SMD |
| 7,0    | 2,5    | 12,0   | FCB-16SG2570120B-XX-SMD |
| 7,0    | 2,5    | 13,0   | FCB-16SG2570130B-XX-SMD |

Type 19

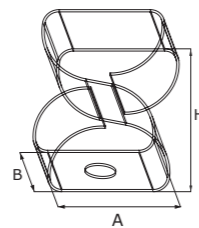

| Dim. A | Dim. B | Dim. H | Item number             |
|--------|--------|--------|-------------------------|
| 4,0    | 3,0    | 5,1    | FCB-198G3040051B-XX-SMD |

Dimensions in mm (unless otherwise stated).

Type 20

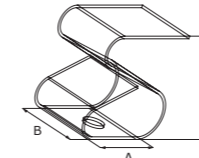

| Dim. A | Dim. B | Dim. H | Item number             |
|--------|--------|--------|-------------------------|
| 3,0    | 2,0    | 3,1    | FCB-205G2030031B-XX-SMD |
| 4,0    | 2,5    | 4,1    | FCB-205G2540041B-XX-SMD |
| 3,5    | 2,0    | 4,2    | FCB-205G2035042B-XX-SMD |
| 7,0    | 2,0    | 6,2    | FCB-205G2070062B-XX-SMD |

Type 21

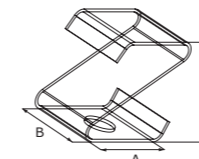

| Dim. A | Dim. B | Dim. H | Item number             |
|--------|--------|--------|-------------------------|
| 2,9    | 2,0    | 2,8    | FCB-21ZG2028028S-XX-SMD |
| 3,5    | 1,4    | 3,4    | FCB-21ZG1435034S-XX-SMD |
| 3,8    | 2,5    | 3,5    | FCB-21ZG2538035B-XX-SMD |
| 4,4    | 2,8    | 4,0    | FCB-21ZG2844040B-XX-SMD |
| 5,0    | 3,0    | 4,0    | FCB-21ZG3050040B-XX-SMD |
| 5,0    | 3,0    | 5,5    | FCB-21012-XX-SMD        |
| 5,0    | 3,0    | 7,0    | FCB-21015-XX-SMD        |
| 5,0    | 3,0    | 7,5    | FCB-21016-XX-SMD        |

Type 22

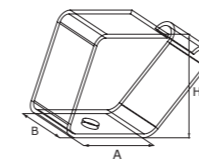

| Dim. A | Dim. B | Dim. H | Item number             |
|--------|--------|--------|-------------------------|
| 6,0    | 2,0    | 4,0    | FCB-22CG2060040B-XX-SMD |

Dimensions in mm (unless otherwise stated).

Type 23

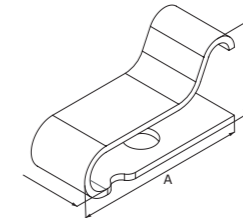

| Dim. A | Dim. B | Dim. H | Item number             |
|--------|--------|--------|-------------------------|
| 2,8    | 1,0    | 1,5    | FCB-23CG1028015B-XX-SMD |

Type 24

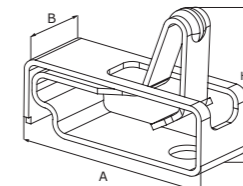

| Dim. A | Dim. B | Dim. H | Item number             |
|--------|--------|--------|-------------------------|
| 3,20   | 0,80   | 1,60   | FCB-24YG1632080B-AU-SMD |
| 3,50   | 1,00   | 1,80   | FCB-24YG1835008B-AU-SMD |
| 2,95   | 1,00   | 2,10   | FCB-24YG2129008T-AU-SMD |
| 4,80   | 1,00   | 2,50   | FCB-24YG2548010B-AU-SMD |
| 3,60   | 1,20   | 3,20   | FCB-24YG3236012T-AU-SMD |
| 3,00   | 2,00   | 3,50   | FCB-24YG3530010T-AU-SMD |



- Customer-specific parts on request
- Samples without tooling costs, serial quantities with low tooling costs
- Detailed information on our website [www.mtc.de/en](http://www.mtc.de/en)





**SMD contact pads** are used exclusively on the printed circuit board and, due to their electrical and physical properties, they are an excellent alternative for grounding of PCBs.

SMD contact pads are characterized by the **following features**:

- high abrasion resistance
- excellent spring properties
- plane-parallel compression at all heights

- excellent electrical conductivity
- high heat resistance
- SMT mountable characteristics for automatic soldering procedure

As an alternative to SMD contact springs SMD contact pads are available in **two versions**:

- Type W: silicone rubber coated with conductive film
- Type S: silicone core coated with conductive silicone paste

**Type W**

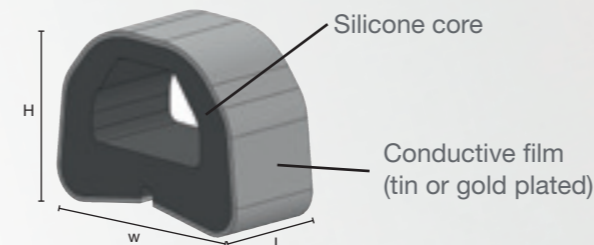

| Dim. W   | Dim. H   | Dim. L  | Item number    |
|----------|----------|---------|----------------|
| 2,0–10,0 | 0,7–12,0 | 1,0–8,4 | SMG-W-BxHxL-XX |

**Type S**

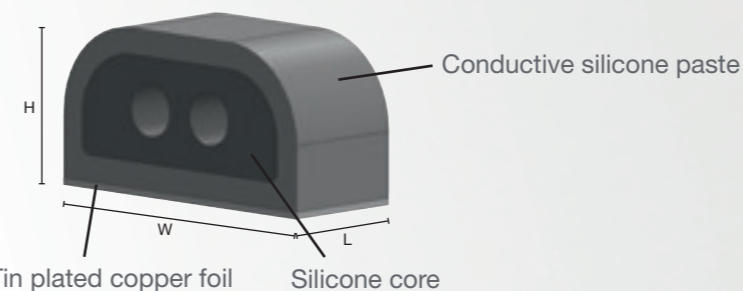

| Dim. W | Dim. H  | Dim. L  | Item number    |
|--------|---------|---------|----------------|
| 2,0    | 0,8–2,5 | 1,0–1,8 | SMG-S-BxHxL-SN |



**Surface refinement**

| Plating     | Material code |
|-------------|---------------|
| gold plated | AU            |
| tin plated  | SN            |



**SMD contact pads provide the following advantages:**

- High adhesion after SMT procedure
- High temperature resistance
- Excellent spring properties
- Excellent grounding characteristics



- Detailed information on our website [www.mtc.de/en](http://www.mtc.de/en)

# SMD Contact Pads





No matter whether they are for prototypes or for mass production, in small or large quantities, **mtc** offers a **cost-efficient way** to protect components directly on the printed circuit board.

### One-piece board level shields for soldering

**One-piece board level shields** represent the **most cost-effective version** with a **maximum shielding effect**. The cover is soldered on the printed circuit board in a **fully automated** way.

### One-piece board level shields with shielding clips

**Shielding clips** are **fully automatically placed** on the printed circuit board. The clips are available as standard articles and therefore additional tooling costs can be saved. The assembly of the covers is done manually or automatically. Due to the removable cover, the underlying components are **accessible at any time**.

### Two-piece board level shields for soldering

Two-piece board level shields consist of a **solderable frame** and a **removable cover**. In addition to an excellent EMI protection, they offer the advantage that components lying under the cover can be **easily maintained and repaired**. The assembly of the frames is **fully automatic**. The installation of the covers is made manually or automatically.

The basic material of the **mtc** board level shields is **SPTE**, the surface is **tin-plated**. In addition to the standard board level shields, **customer-specific parts** can be manufactured on request.

To avoid **heat development** and disorders of the components, it is advisable to provide **air holes** in the shielding cover.

**mtc** also offers the possibility to integrate a **thermally conductive gap filler** in the shielding cover if a **high heat dissipation** is required.

If a higher shielding effect in the **high-frequency range** is required, it is possible to integrate **microwave absorbers**.



For reasons of space only schematic drawings are used.

**Please request the technical documentation with the proposal for the pad before you start the design of the printed circuit board. You can also find it on our website.**

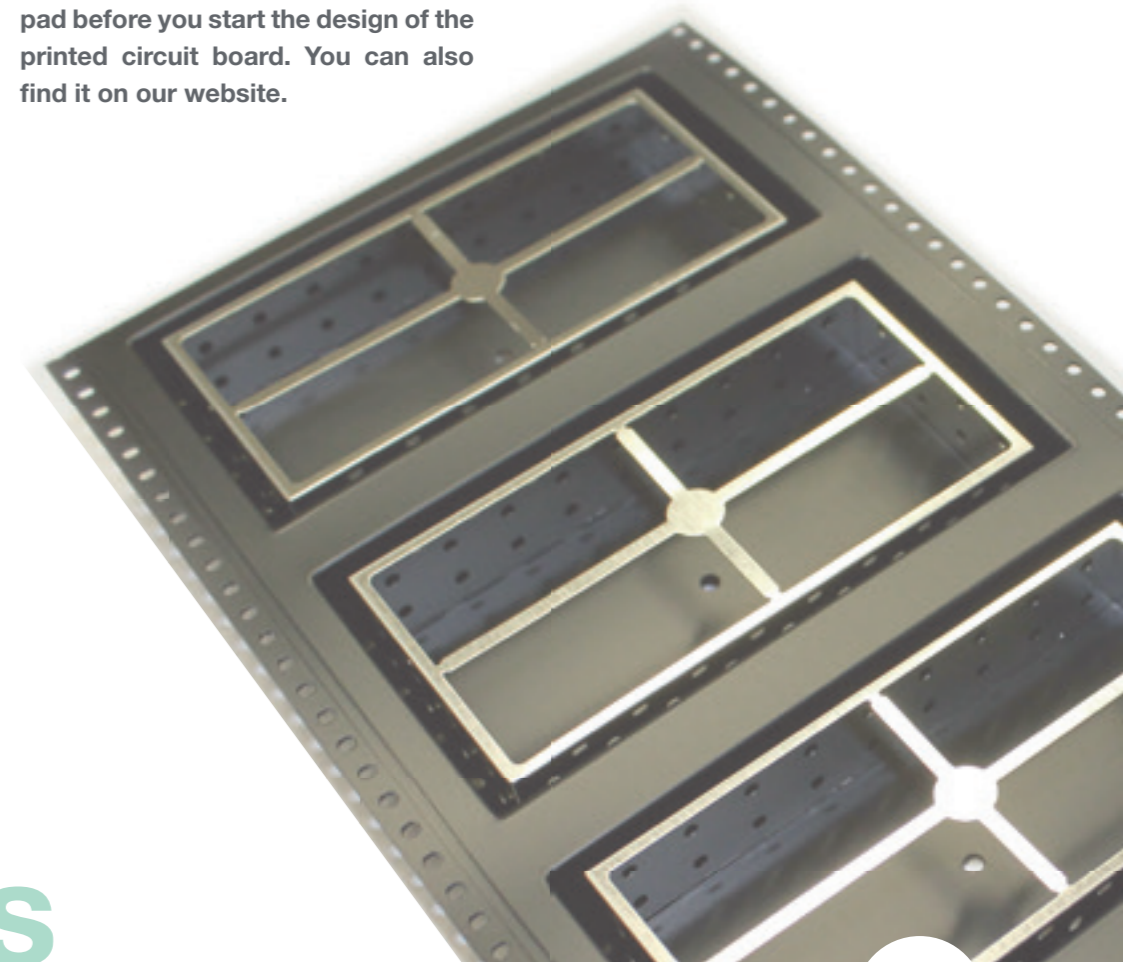
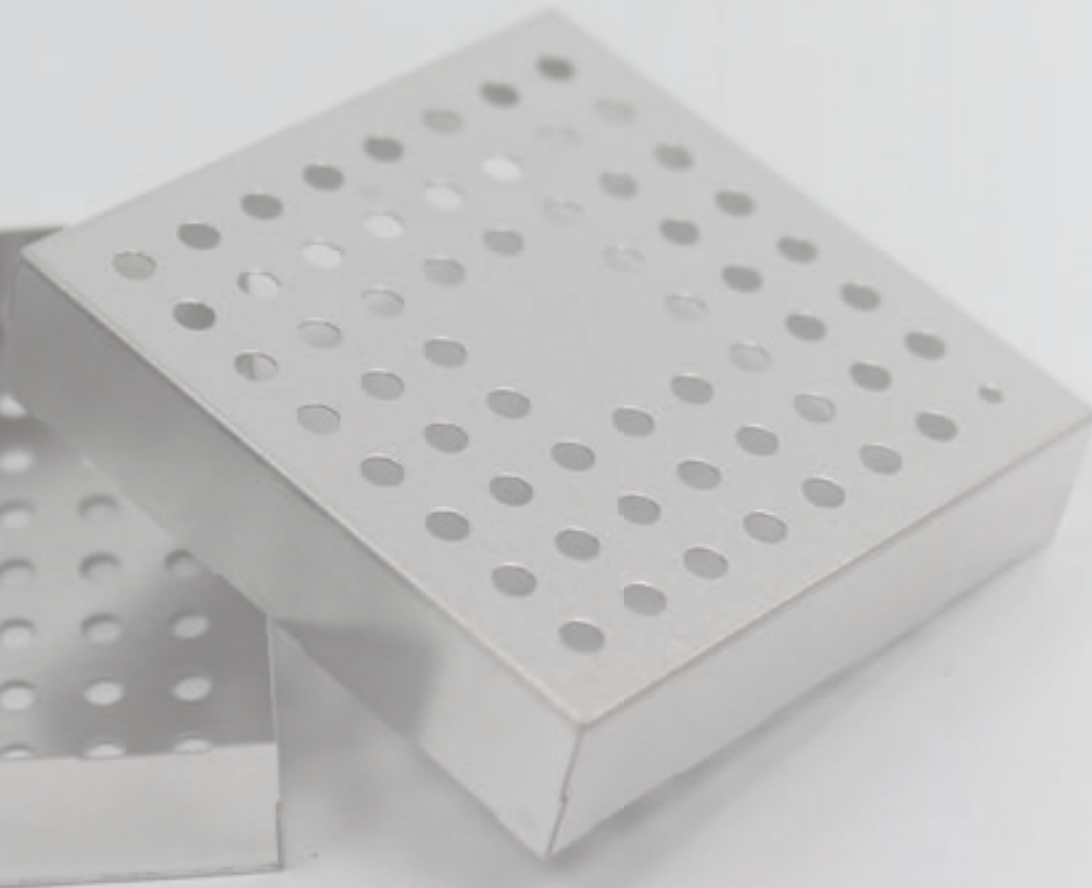

# Board Level Shields and Shielding Clips

One-piece board level shields for soldering

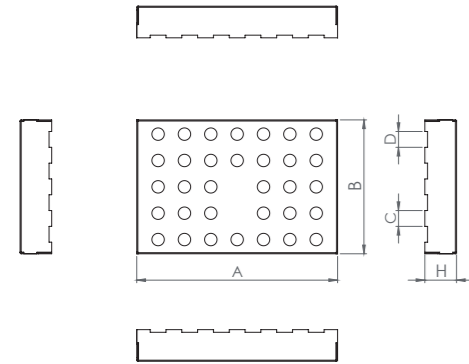

| Dimension A | Dimension B | Dimension C | Dimension D | Dimension H | Material thickness | Item number                     |
|-------------|-------------|-------------|-------------|-------------|--------------------|---------------------------------|
| 13,66       | 12,70       | 3,00        | 3,00        | 2,54        | 0,20               | SGH-13,66x12,70x2,54x0,20-FS-OP |
| 16,50       | 16,50       | 3,00        | 3,00        | 3,60        | 0,20               | SGH-16,50x16,50x3,60x0,20-FS-OP |
| 26,21       | 26,21       | 3,00        | 3,00        | 5,08        | 0,20               | SGH-26,21x26,21x5,08x0,20-FS-OP |
| 29,36       | 18,50       | 3,00        | 3,00        | 7,00        | 0,20               | SGH-29,36x18,50x7,00x0,20-FS-OP |
| 32,00       | 32,00       | 3,00        | 3,00        | 6,00        | 0,20               | SGH-32,00x32,00x6,00x0,20-FS-OP |
| 36,83       | 33,68       | 3,00        | 3,00        | 5,08        | 0,20               | SGH-36,83x33,68x5,08x0,20-FS-OP |
| 38,10       | 25,40       | 3,00        | 3,00        | 6,00        | 0,20               | SGH-38,10x25,40x6,00x0,20-FS-OP |
| 39,60       | 39,60       | 3,00        | 3,00        | 7,00        | 0,20               | SGH-39,60x39,60x7,00x0,20-FS-OP |
| 44,00       | 30,50       | 3,00        | 3,00        | 3,00        | 0,20               | SGH-44,00x30,50x3,00x0,20-FS-OP |
| 44,37       | 44,37       | 3,00        | 3,00        | 9,75        | 0,20               | SGH-44,37x44,37x9,75x0,20-FS-OP |

One-piece board level shields with shielding clips

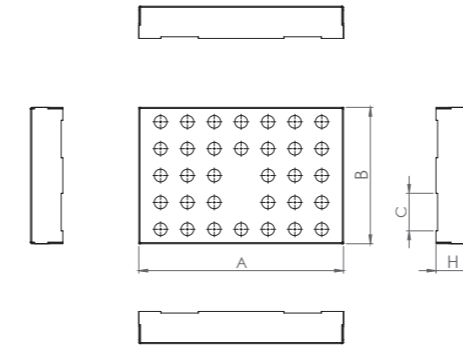

| Dimension A | Dimension B | Dimension C | Dimension H | Material thickness | Item number                     |
|-------------|-------------|-------------|-------------|--------------------|---------------------------------|
| 13,66       | 12,70       | 7,00        | 2,54        | 0,20               | SGH-13,66x12,70x2,54x0,20-FS-SC |
| 16,50       | 16,50       | 7,00        | 3,60        | 0,20               | SGH-16,50x16,50x3,60x0,20-FS-SC |
| 26,21       | 26,21       | 7,00        | 5,08        | 0,20               | SGH-26,21x26,21x5,08x0,20-FS-SC |
| 29,36       | 18,50       | 7,00        | 7,00        | 0,20               | SGH-29,36x18,50x7,00x0,20-FS-SC |
| 32,00       | 32,00       | 7,00        | 6,00        | 0,20               | SGH-32,00x32,00x6,00x0,20-FS-SC |
| 36,83       | 33,68       | 7,00        | 5,08        | 0,20               | SGH-36,83x33,68x5,08x0,20-FS-SC |
| 38,10       | 25,40       | 7,00        | 6,00        | 0,20               | SGH-38,10x25,40x6,00x0,20-FS-SC |
| 39,60       | 39,60       | 7,00        | 7,00        | 0,20               | SGH-39,60x39,60x7,00x0,20-FS-SC |
| 44,00       | 30,50       | 7,00        | 3,00        | 0,20               | SGH-44,00x30,50x3,00x0,20-FS-SC |
| 44,37       | 44,37       | 7,00        | 9,75        | 0,20               | SGH-44,37x44,37x9,75x0,20-FS-SC |

Standard shielding clips



| Length | Width | Height | Piece (roll) | Thickness shielding cover | Coating | Material        | Item number                  |
|--------|-------|--------|--------------|---------------------------|---------|-----------------|------------------------------|
| 6,50   | 0,80  | 1,27   | 10.000       | 0,15–0,20                 | SN      | Stainless steel | SC-6,50x0,80x1,27-TC-0,15EMB |



- Customer-specific parts on request
- Samples without tooling costs, serial quantities with low tooling costs
- Get detailed information on our website [www.mtc.de/en](http://www.mtc.de/en)



- Other **shielding clips** on request
- Customer-specific parts on request
- Samples without tooling costs, serial quantities with low tooling costs
- Detailed information on our website [www.mtc.de/en](http://www.mtc.de/en)

Dimensions in mm (unless otherwise stated).

Dimensions in mm (unless otherwise stated).